

## TPE-X Electric Highlifter Manufactured In Stainless Steel

The TPE-X highlifter is designed to lift a pallet or stillage to a comfortable working height to reduce repetitive bending and stretching. Lifting is by battery-electric pump.

- Capacity 1000 Kg
- Manufactured from 100% 304 grade stainless steel, ideal for use in food, chemical and pharmaceuticals industries.
- This electric truck is protected to IP54 so can be hose washed.
- Suitable for working in areas down to -30°C.
- Trucks carry CE mark and comply with all current safety legislation.

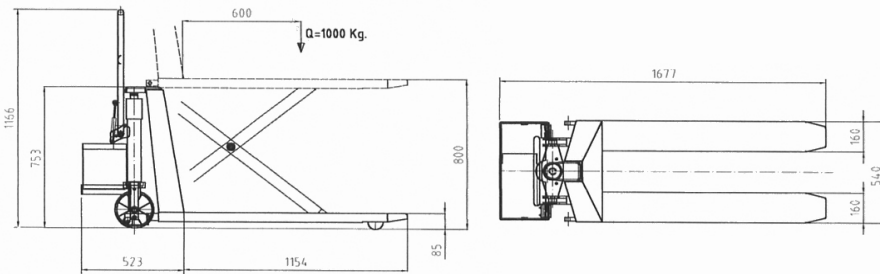

TPE-X



Special Order Only

### The TPE-X Hand Electro-Hydraulic High-Lifter

- Capacity 1000 Kg
- Robust pump unit can be hose-washed.
- Supplied complete with heavy duty battery and external battery charger. Battery isolator switch is fitted for safety.
- Also available in other fork width 680 mm and fork lengths of up to 2000 mm.
- Trucks carry CE mark and comply with all current safety legislation.

Model	TPE-X	
Capacity	Kg	1000
Fork Width	mm	540      680
Fork Length	mm	1140, 1300, 1400, 1500, 1600, 1700, 1800 + 2000
Lift Height	mm	800
Net Weight	Kg	160
Wheels	mm	175 x 50
Rollers	mm	80 x 90
Battery	V/Ah	12/100
Charger	V/A	12/15



**H.E.S**  
HANDLING EQUIPMENT SALES LTD.

Tel: 01525 717174  
Fax: 01525 717140

info@hesales.co.uk  
www.hesales.co.uk