

RECORD

Materials Handling Equipment

Record Fully Powered Pallet Truck

- Model WP-LPT, Capacities 1500kg + 2200kg
- Available in widths 520 & 650 mm.
- Approved good acceleration enhances efficient pallet entry and exit to increase productivity. No-polar electronic-control is programmable for specific tasks or operator skill levels.
- Smooth travel and lift combined with excellent controls reducing product damage and increasing productivity.
- High Quality hydraulic pump assures very little noise, maximum efficiency and durability.
- Drive unit is equipped with an electro-magnetic brake that is spring applied and electrically released. Brake is activated by the control handle position. Ergonomically designed control handle with buttons for raising lowering and honking.
- Lift limit switch operates at maximum lift height, shutting off pump motor
- Small + Light, ideal for use in confined areas
- **OPTION: Driver Platform + Side Protection bars (WP-LPT 22)**

WP-LPT15

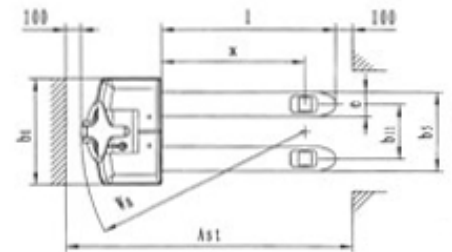
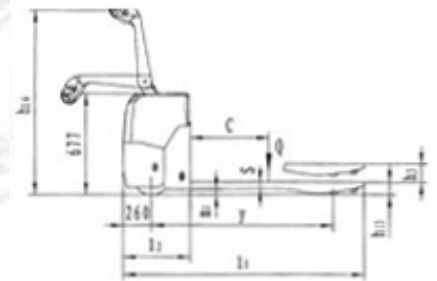

The WP-LPT22 can be equipped with platform and side protection bars making the operator feel more comfortable

WP-LPT22



Model		WP-LPT15/1	WP-LPT15/2	WP-LPT22/1	WP-LPT22/2	WP-LPT22/3	WP-LPT22/4
Capacity	Kg	1500			2200		
Fork Length (L1)	mm	1150	1220	1150	1150	1220	1220
Fork Spread (W)	mm	520	650	540	685	540	685
Fork Spacing (W1)	mm	200	330	220	365	220	365
Overall Length (L)	h (mm)	1590	1660	1815	1885	1815	1885
Fork Height (h – min)	mm	85	75	85	75	85	75
Fork Height (h – max)	mm)	120					
Load Rollers	mm	Ø 84 Tandem Nylon, Polyurethane					
Steer Wheels	mm	Ø 252 Nylon, Polyurethane, Rubber					



H.E.S.
HANDLING EQUIPMENT SALES LTD.

Tel: 01525 717174
Fax: 01525 717140

info@hesales.co.uk
www.hesales.co.uk

