

CLC Fully Powered Stacker

CLC1229

- **Model: CLC1229, Capacity 1200kg.**
- **Maximum Lift Height 2820mm.**
- **The CLC1229 is a fully powered stacker that provides smooth travel and lift with easy to operate controls.**
- **High quality hydraulic pump assures very little noise, maximum efficiency and durability.**
- **Lift limit switch operates at maximum lift height to shut off pump motor.**
- **Electromagnetic braking that is spring applied and**



electrically released.

- **Speed automatically reduces when driving with fork raised at or above 12".**
- **The CURTIS electronic controller helps provide plenty of low end torque while increasing the motor and battery life.**
- **Excellent stability in operation.**

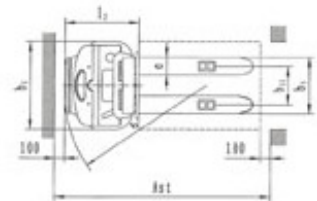
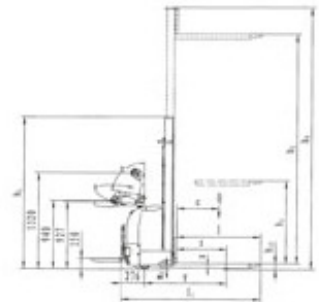

Model	CLC1229	
Capacity	Kg	1200
At load centre	mm	600
Wheels	mm	polyurethane
Lift Height (h2)	mm	2820
Freelift	mm	158
Lowered Height (h1)	mm	1951
Raised Height (h3)	mm	3265
Width over forks	mm	570
Fork Length	mm	1150
Overall Width	mm	890
Overall Length	mm	1831



H.E.S.
HANDLING EQUIPMENT SALES LTD.

Tel: 01525 717174
Fax: 01525 717140

info@hesales.co.uk
www.hesales.co.uk

